

 **WEALTHMARK**  
Limited



**Copper**  
**Pipe, Fittings & Valves**



水務供應部  
Water Supplier Department  
400-415 德輔道中 400-415  
Wing Lok Street, The Kwongming Bank Building, Hong Kong

電話 2829 4467 傳真 2824 0378  
電話 (4) 或 WSD 2106 5894 或 1 (182) 18 July 2002

Woolbrook Ltd.  
Room 3001, 10/F.,  
The Kwongming Provincial Bank Bldg.,  
400-415 Hingmoy Road,  
Hong Kong.

(Attn.: Mr. Leo NGOK)

Dear Sir,

**Application for Approval of  
"Woolbrook" Copper Fittings**

Your letter ref. W/L/02060 dated 8 July 2002 refers.

Please be advised that copper fittings complying with the relevant updated British Standards and Waterworks Regulations can be used in plumbing works. Under our current practice, a letter specifically signifying the general acceptance of a particular brand of copper fittings is not necessary.

Your attention is drawn to the requirements specified in paragraph 2 and 3 of Part I of Schedule 2 of the Waterworks Regulations.

Yours faithfully,

J. W. Ho, Paul  
for Water Authority



水務署  
Water Supplier Department  
400-415 德輔道中 400-415  
Wing Lok Street, The Kwongming Bank Building

電話 2829 4467 傳真 2824 0378  
電話 (4) 或 WSD 2106 5894 或 1 (182) 28 January 2007

Woolbrook Ltd.  
Room 1401-2, 14/F.,  
The Kwongming Provincial Bank Bldg.,  
400-415 Hingmoy Road,  
Hong Kong.

(Attn.: Madam Maggie LEE)

Dear Sir,

**Approval of  
"Woolbrook" General (GG) Gate Valves**

Your letter ref. W/L/07007 dated 18 January 2007 refers.

Having considered the test reports by the Nishik Systems, Ltd., the Authority accepts that the fittings described below comply with, and their use when correctly installed does not contravene, the Waterworks Ordinance and Regulations.

Name of Manufacturer: Woolbrook (Ningbo Jangshu) Copper Products.

Country of Origin: China.

Brand: Woolbrook.

Details of Fittings: 35, 28 and 25mm General (GG) gate valves (no internally applied metallic coating) to Series A of BS 5154 with screwed ends to BS21.  
Pressure Rating: PN 16.  
Model No.: WGV-301T-3C.  
Body Markings:



(\*BS\* denotes 35, 28 or 10)

This Authority hereby permits the use of the above fittings in fresh water

Acceptance Reference No. C10076022

Page: 1



水務署  
Water Supplier Department  
400-415 德輔道中 400-415  
Wing Lok Street, The Kwongming Bank Building

電話 2829 4467 傳真 2824 0378  
電話 (4) 或 WSD 2106 5894 或 1 (182) 12 January 2007

Woolbrook Ltd.  
Rm. 1401-2, 14/F.,  
The Kwongming Provincial Bank Bldg.,  
400-415 Hingmoy Road,  
Hong Kong.

(Attn.: Madam Maggie LEE)

Dear Sir,

**Approval of "Woolbrook"  
General Loose Jumper Stop Valves**

Your letter ref. W/L/06023 dated 1 December 2006 refers.

Having considered the test reports by the Nishik Systems, Ltd., the Authority accepts that the fittings described below comply with, and their use when correctly installed does not contravene, the Waterworks Ordinance and Regulations.

Name of Manufacturer: Woolbrook (Ningbo Jangshu) Copper Products.

Country of Origin: China.

Brand: Woolbrook.

Details of Fittings: 15, 20 and 25mm General stop valves (no internally applied metallic coating), loose jumper type.  
Model No.: WJV-001T02.  
Body Markings:



(\*BS\* denotes 15, 20 or 25)

This Authority hereby permits the use of the above fittings in fresh water plumbing systems subject to full adherence to Waterworks installation requirements.

Acceptance Reference No. C20070010

Page: 1



水務署  
Water Supplier Department  
400-415 德輔道中 400-415  
Wing Lok Street, The Kwongming Bank Building

電話 2829 4467 傳真 2824 0378  
電話 (4) 或 WSD 2106 5894 或 1 (182) 1 February 2006

Woolbrook Ltd.  
Room 1401-2, 14/F., The Kwongming Provincial Bank Building,  
400-415 Hingmoy Road,  
Hong Kong.

(Attn.: Ms. Maggie LEE)

Dear Sir,

**Approval of  
"Woolbrook" Brown-general Gate Valves**

Your letter ref. W/L/05003 dated 24 January 2006 and (re:\*) dated 23 January 2005 refers.

Having considered the test reports by the Nishik Systems, Ltd., the Authority accepts that the fittings described below comply with, and their use when correctly installed does not contravene, the Waterworks Ordinance and Regulations.

Name of Manufacturer: Woolbrook (Ningbo Jangshu) Copper Products.

Country of Origin: China.

Brand: Woolbrook.

Details of Fittings: 10", 1 1/2" and 2" Brown-general gate valve (no internally applied metallic coating) with screwed ends to BS 5154, to series A, of BS 5154, for fresh water and all water applications.  
Pressure Rating: PN 16.  
Model No.: WGV-301T-3C.  
Body Markings:



(\*BS\* denotes 70, 15 and 2)

Acceptance Reference No. C20050014

Page: 1

# Copper Pipe Fittings And Valves

## INDEX

---

Introduction	P.1
The Dimensions of Copper Pipe	P.2
End Feed Fittings	P.3 - 4
Solder Ring Fittings	P.5 - 6
Compression Fittings/Flanged Fittings	P.7 - 8
End Feed Fittings (ASME)	P.9 - 10
Gunmetal-Bronze Gate Valves Gunmetal-Bronze Loose Jumper Stop Valves	P.11
Copper Alloy Gate Valves & Copper Alloy Flanged Gate Valves	P.12
Copper Alloy Globe Valves & Copper Alloy Flanged Globe Valves	P.13
Copper Alloy Check Valves & Copper Alloy Flanged Check Valves	P.14
Copper Alloy Stop Valves & Copper Alloy Ball Valves	P.15

## **I**NTRODUCTION

---

The name  **WEALTHMARK** has become the synonymous with high quality products and professional customer services at the most competitive prices.

 **WEALTHMARK**'s copper pipe, fittings and valves are extremely outstanding among others, for plumbing and drainage systems in the construction business.

The major products for  **WEALTHMARK** are the copper pipe, capillary end feed fittings, solder ring fittings, compression fittings, flanged fittings and different valves. All manufacturing procedures and quality control are complied with the quality management system BS EN ISO 9001:2000. The products are manufactured to the relevant British Standard, EN and ASME / ANSI Standard.

Furthermore, we will be more than happy to create and manufacture as well as modify other copper pipe fittings according to customer's requirements.

We also manufacture SAE Standard high pressure copper pipe fittings for pneumatic system.

All products are produced from the following copper alloy designations as raw materials which comply with the relevant standards:

American Standard	ASTM	C3600 & C3700
European Standard	ISO	CuZn39Pb2 & CuZn40Pb2
Japanese Standard	JIS	C3604 & C3771

One of our mission is to continue developing our products and providing our customers with the best service in order to satisfy their needs.

## THE DIMENSIONS OF COPPER PIPE

**WEALTHMARK** manufactures a wide range of copper pipes comply to both EN 1057 and ASTM B88 standard. Our pipes could be plastic coated to prevent corrosion from external sources (such as soil, concrete, plaster when buried, or corrosive atmospheres in production areas, etc.)

Besides, our pipes with a profile plastic coating designed to trap air. This is not only resists corrosion when buried but reduces heat loss and is therefore most suitable for heating systems.

### The Dimensions of Copper Pipe to BS EN 1057:1996

Size (mm)	Wall Thickness (mm)	Outside Dia. (mm)		Max. Working Pressure (Kpa)
		Max.	Min.	
15	0.7	15.045	14.965	5800
22	0.9	22.055	21.975	5100
28	0.9	28.055	27.975	4000
35	1.2	35.070	37.990	4200
42	1.2	42.070	41.990	3500
54	1.2	54.070	53.990	2700
67	1.2	60.750	66.600	2000
76	1.5	76.300	76.150	2400
108	1.5	108.25	108.00	1700
159	2.0	159.50	159.25	1500

### The Dimensions of Copper Pipe to ASTM B 88 Type "L"

Nominal Size (Inch)	Outside Diameter		Nominal Thickness		Weight Per Foot	
	Inch	(mm)	Inch	(mm)	Lb	(kg)
1/4	0.375	(9.53)	0.030	(0.76)	0.126	(0.06)
3/8	0.500	(12.70)	0.035	(0.89)	0.198	(0.09)
1/2	0.625	(15.88)	0.040	(1.02)	0.285	(0.13)
5/8	0.750	(19.05)	0.042	(1.07)	0.362	(0.16)
3/4	0.875	(22.23)	0.045	(1.14)	0.455	(0.21)
1	1.125	(28.58)	0.050	(1.27)	0.655	(0.30)
1.1/4	1.375	(34.93)	0.055	(1.40)	0.884	(0.40)
1.1/2	1.625	(41.28)	0.060	(1.52)	1.140	(0.52)
2	2.125	(53.98)	0.070	(1.78)	1.750	(0.79)
2.1/2	2.625	(66.68)	0.080	(2.03)	2.480	(1.12)
3	3.125	(79.38)	0.090	(2.29)	3.330	(1.51)
3.1/2	3.625	(92.08)	0.100	(2.54)	4.290	(1.95)
4	4.125	(104.78)	0.110	(2.79)	5.380	(2.44)
5	5.125	(130.18)	0.125	(3.18)	7.610	(3.45)
6	6.125	(155.58)	0.140	(3.56)	10.200	(4.63)
8	8.125	(206.38)	0.200	(5.08)	19.290	(8.75)
10	10.125	(257.18)	0.250	(6.35)	30.100	(13.65)
12	12.125	(307.98)	0.280	(7.11)	40.400	(18.33)

Reducing Tee dimensions are specified as:

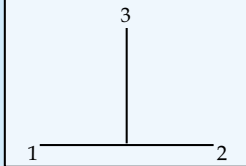

**WEALTHMARK** end feed capillary and weldable fittings (WE series) are manufactured in accordance with EN1254 (BS 864: Part 2), suitable for tap water. All fittings are manufactured by high quality copper to EN 1057 and high quality brass. The threads are in accordance with BS 21.

The dimensions for **WEALTHMARK** end feed capillary and weldable fittings vary from 15mm to 159mm. There are many different sizes for easy installation. The relevant working temperature and working pressure are as follows:

30°C - 16 Bar; 65°C - 10 Bar and 110°C - 6 Bar.

## END FEED FITTINGS



C x C  
mm  
15, 22, 28, 35,  
42, 54, 67, 76,  
108, 133, 159

**Straight Coupling  
(WE 201)**



C x C  
mm  
15, 22, 28, 35,  
42, 54, 67, 76,  
108, 133, 159

**90° Elbow  
(WE 205)**



C x C  
mm  
22 x 15,  
28 x (15, 22),  
35 x (15, 22, 28),  
42 x (15, 22, 28, 35),  
54 x (28, 35, 42),  
67 x (35, 42, 54),  
76 x (42, 54, 67),  
108 x (54, 67, 76),  
133 x (67, 76, 108),  
159 x (76, 108, 133)

**Reducing Coupling  
(WE 202)**



C x C x C  
mm  
15, 22, 28, 35,  
42, 54, 67, 76,  
108, 133, 159

**90° Equal Tee  
(WE 206)**



C x C  
mm  
22 x 15,  
28 x (15, 22),  
35 x (15, 22, 28),  
42 x (15, 22, 28, 35),  
54 x (28, 35, 42),  
67 x (35, 42, 54),  
76 x (42, 54, 67),  
108 x (54, 67, 76),  
133 x (67, 76, 108),  
159 x (76, 108, 133)

**Fitting Reducer  
(WE 203)**



C x C x C  
mm  
22 x 22 x 15,  
28 x 28 x (15, 22),  
35 x 35 x (15, 22, 28),  
42 x 42 x (15, 22, 28, 35),  
54 x 54 x (28, 35, 42),  
67 x 67 x (35, 42, 54),  
76 x 76 x (42, 54, 67),  
108 x 108 x (54, 67, 76),  
133 x 133 x (67, 76, 108),  
159 x 159 x (76, 108, 133)

**Reducing Tee  
(WE 207)**



C x C  
mm  
15, 22, 28, 35,  
42, 54, 67, 76,  
108, 133, 159

**45° Elbow  
(WE 204)**



C x C x C  
mm  
22 x 15 x 22,  
28 x (15, 22) x 28,  
35 x (22, 28) x 35,  
42 x (28, 35) x 42,  
54 x (35, 42) x 54,  
67 x (42, 54) x 67,  
76 x (54, 67) x 76,  
108 x (67, 76) x 108,  
133 x (76, 108) x 133,  
159 x (108, 133) x 159

**Reducing Tee End  
(WE 208)**

## END FEED FITTINGS



C x C x C  
mm  
15 x 15 x 22,  
22 x 22 x 28,  
28 x 28 x 35,  
35 x 35 x 42,  
42 x 42 x 54

**Reducing Tee Both End  
(WE 209)**



C x F  
mm x BSP  
15 x 1/2", 22 x 3/4",  
28 x 1", 35 x 1.1/4",  
42 x 1.1/2", 54 x 2"

**Female Adaptor  
(WE 213)**



C  
mm  
15, 22, 28, 35,  
42, 54, 67, 76,  
108, 133, 159

**End Cap  
(WE 210)**



C x M  
mm x BSP  
15 x 1/2", 22 x 3/4",  
28 x 1", 35 x 1.1/4",  
42 x 1.1/2", 54 x 2"

**Male Adaptor  
(WE 214)**



C x F  
mm x BSP  
15 x 1/2", 22 x 3/4",  
28 x 1", 35 x 1.1/4",  
42 x 1.1/2", 54 x 2"

**Female Elbow  
(WE 211)**



C x C  
mm  
15, 22, 28,  
35, 42, 54,

**Straight Union  
(WE 215)**



C x M  
mm x BSP  
15 x 1/2", 22 x 3/4",  
28 x 1", 35 x 1.1/4",  
42 x 1.1/2", 54 x 2"

**Male Elbow  
(WE 212)**



C x F  
mm x BSP  
15 x 1/2"

**Wall Mount Elbow  
(WE 216)**

Reducing Tee dimensions are specified as:

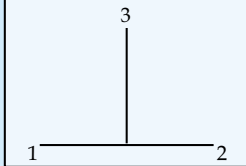

**WEALTHMARK** potable integral solder ring fittings (WS Series) are manufactured in accordance with EN1254 (BS 864: Part 2) with lead-free solder, suitable for tap water. All fittings are manufactured by high quality copper to EN 1057 and brass. The threads are in accordance with BS 21.

The dimensions for **WEALTHMARK** potable integral solder ring fittings vary from 15mm to 54mm. There are many different selections for easy installation. The relevant working temperature and working pressure are as follows:  
30°C - 16 Bar; 65°C - 10 Bar and 110°C - 6 Bar.

## SOLDER RING FITTINGS



C x C  
mm  
15, 22, 28,  
35, 42, 54,

**Straight Coupling  
(WS 101)**



C x C  
mm  
15, 22, 28,  
35, 42, 54

**90° Elbow  
(WS 105)**



C x C  
mm  
22 x 15, 28 x 15,  
28 x 22, 35 x 22,  
35 x 28, 42 x 28,  
42 x 35, 54 x 35,  
54 x 42

**Reducing Coupling  
(WS 102)**



C x C  
mm  
15, 22, 28,  
35, 42, 54

**Equal Tee  
(WS 106)**



C x C  
mm  
22 x 15, 28 x 15,  
28 x 22, 35 x 15,  
35 x 22, 35 x 28,  
42 x 15, 42 x 22,  
42 x 28, 42 x 35,  
54 x 15, 54 x 22,  
54 x 28, 54 x 35,  
54 x 42

**Fitting Reducer  
(WS 103)**



C x C x C  
mm  
22 x 22 x 15, 28 x 28 x 15,  
28 x 28 x 22, 35 x 35 x 15,  
35 x 35 x 22, 35 x 35 x 28,  
42 x 42 x 15, 42 x 42 x 22,  
42 x 42 x 28, 42 x 42 x 35,  
54 x 54 x 22, 54 x 54 x 28,  
54 x 54 x 35, 54 x 54 x 42

**Reducing Tee  
(WS 107)**



C x C  
mm  
15, 22, 28,  
35, 42, 54

**45° Elbow  
(WS 104)**



C x C x C  
mm  
22 x 15 x 22, 28 x 15 x 28,  
28 x 22 x 28, 35 x 15 x 35,  
35 x 22 x 35, 35 x 28 x 35,  
42 x 28 x 42, 42 x 35 x 42,  
54 x 35 x 54, 54 x 42 x 54

**Reducing Tee End  
(WS 108)**



## SOLDER RING FITTINGS



C x C x C  
mm  
15 x 15 x 22,  
15 x 15 x 28,  
22 x 22 x 28

**Reducing Tee Both End  
(WS 109)**



C x F  
mm x BSP  
15 x 1/2", 22 x 3/4",  
28 x 1", 35 x 1.1/4",  
42 x 1.1/2", 54 x 2"

**Female Adaptor  
(WS 113)**



C  
mm  
15, 22, 28,  
35, 42, 54

**End Cap  
(WS 110)**



C x M  
mm x BSP  
15 x 1/2", 22 x 3/4",  
28 x 1", 35 x 1.1/4",  
42 x 1.1/2", 54 x 2"

**Male Adaptor  
(WS 114)**



C x F  
mm x BSP  
15 x 1/2", 22 x 3/4",  
28 x 1", 35 x 1.1/4",  
42 x 1.1/2", 54 x 2"

**Female Elbow  
(WS 111)**



C x C  
mm  
15, 22, 28,  
35, 42, 54,

**Straight Union  
(WS 115)**



C x M  
mm x BSP  
15 x 1/2", 22 x 3/4",  
28 x 1", 35 x 1.1/4",  
42 x 1.1/2", 54 x 2"

**Male Elbow  
(WS 112)**

## COMPRESSION FITTINGS

**WEALTHMARK** compression fittings (WC Series) are manufactured in accordance with EN1254 (BS 864: Part 2) and BS 4504 PN 16, suitable for tap water. All fittings are manufactured by high quality copper and copper alloys to EN 1057 and brass. The threads are in accordance with BS 21.

The dimensions for **WEALTHMARK** compression fittings vary from 15mm to 35mm, whereas the flanged fittings are from 54mm to 159mm. There are many different sizes for easy installation. The relevant working temperature and working pressure are as follows:  
30°C - 16 Bar; 65°C - 10 Bar and 110°C - 6 Bar.



C x C  
mm  
15, 22, 28, 35

**Straight Coupling  
(WC 301)**



C x C x C  
mm  
22 x 22 x 15, 28 x 28 x 15,  
28 x 28 x 22, 35 x 35 x 15,  
35 x 35 x 22, 35 x 35 x 28

**Reducing Tee  
(WC 305)**



C x C  
mm  
22 x 15, 28 x 15,  
28 x 22, 35 x 15,  
35 x 22, 35 x 28

**Reducing Coupling  
(WC 302)**



C  
mm  
15, 22, 28, 35

**End Cap  
(WC 306)**



C x C  
mm  
15, 22, 28, 35

**90° Elbow  
(WC 303)**



C x F  
mm x BSP  
15 x 1/2", 22 x 3/4",  
28 x 1", 35 x 1.1/4"

**Female Elbow  
(WC 307)**



C x C x C  
mm  
15, 22, 28, 35

**Equal Tee  
(WC 304)**



C x M  
mm x BSP  
15 x 1/2", 22 x 3/4",  
28 x 1", 35 x 1.1/4"

**Male Elbow  
(WC 308)**

## COMPRESSION FITTINGS



C x F  
mm x BSP  
15 x 1/2", 22 x 3/4",  
28 x 1", 35 x 1.1/4",

**Female Adaptor  
(WC 309)**



C x F  
mm x BSP  
15 x 1/2"

**Wall Mount Elbow  
(WC 311)**



C x M  
mm x BSP  
15 x 1/2", 22 x 3/4",  
28 x 1", 35 x 1.1/4",

**Male Adaptor  
(WC 310)**



C x F  
mm x BSP  
15, 22, 28

**Ring & Nut  
(WC 312)**

## FLANGED FITTINGS

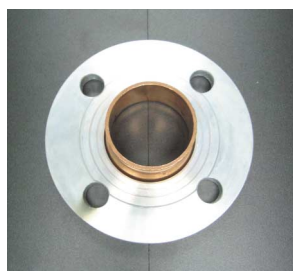

F x F  
mm  
54, 67, 76,  
108, 133, 159

**Slip-On Flange  
(WF 406)**

Reducing Tee dimensions are specified as:

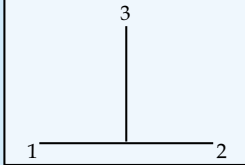

**WEALTHMARK** end feed capillary and weldable fittings (WEA Series) are manufactured in accordance with ASME B16.22, suitable for tap water. All fittings are manufactured by high quality copper to ASTM B88 and high quality brass. The threads are in accordance with ANSI / ASME B16.15.

The dimensions for **WEALTHMARK** end feed capillary and weldable fittings vary from 1/2" to 4". There are many different sizes for easy installation. The relevant working temperature and working pressure are as follows:  
30°C - 16 Bar; 65°C - 10 Bar and 110°C - 6 Bar.

## END FEED FITTINGS (ASME)



**Straight Coupling**  
(WEA 501)

C x C  
1/4, 3/8, 1/2, 5/8,  
3/4, 1, 1.1/4, 1.1/2,  
2, 2.1/2, 3, 3.1/2, 4



**90° Elbow**  
(WEA 505)

C x C  
1/4, 3/8, 1/2, 5/8,  
3/4, 1, 1.1/4, 1.1/2,  
2, 2.1/2, 3, 3.1/2, 4



**Reducing Coupling**  
(WEA 502)

C x C  
1/4x1/8, 3/8x1/4,  
1/2x(1/4, 3/8),  
5/8x(1/4, 3/8, 1/2),  
3/4x(1/4, 3/8, 1/2, 5/8),  
1x(3/8, 1/2, 5/8, 3/4),  
1.1/4x(1/2, 5/8, 3/4, 1),  
1.1/2x(1/2, 3/4, 1, 1.1/4),  
2x(1/2, 3/4, 1, 1.1/4, 1.1/2),  
2.1/2x(1, 1.1/4, 1.1/2, 2),  
3x(1, 1.1/4, 1.1/2, 2, 2.1/2),  
3.1/2x3, 4x(3, 3.1/2)



**90° Equal Tee**  
(WEA 506)

C x C x C  
1/4, 3/8, 1/2, 5/8,  
3/4, 1, 1.1/4, 1.1/2,  
2, 2.1/2, 3, 3.1/2, 4



**Fitting Reducer**  
(WEA 503)

C x C  
1/4x1/8, 3/8x1/4,  
1/2x(1/4, 3/8),  
5/8x(1/4, 3/8, 1/2),  
3/4x(1/4, 3/8, 1/2, 5/8),  
1x(3/8, 1/2, 5/8, 3/4),  
1.1/4x(1/2, 5/8, 3/4, 1),  
1.1/2x(1/2, 5/8, 3/4, 1, 1.1/4),  
2x(1/2, 3/4, 1, 1.1/4, 1.1/2),  
2.1/2x(1, 1.1/4, 1.1/2, 2),  
3x(1, 1.1/4, 1.1/2, 2, 2.1/2),  
3.1/2x3, 4x(3, 3.1/2)



**Reducing Tee**  
(WEA 507)

C x C x C  
1/4x1/4x1/8, 3/8x3/8x1/4,  
1/2x1/2x(1/4, 3/8),  
5/8x5/8x(1/4, 3/8, 1/2),  
3/4x3/4x(1/4, 3/8, 1/2, 5/8),  
1x1x(1/4, 3/8, 1/2, 5/8, 3/4),  
1.1/4x1.1/4x(3/8, 1/2, 5/8, 3/4, 1),  
1.1/2x1.1/2x(1/2, 5/8, 3/4, 1, 1.1/4),  
2x2x(1/2, 3/4, 1, 1.1/4, 1.1/2),  
2.1/2x2.1/2x(3/4, 1, 1.1/4, 1.1/2, 2),  
3x3x(1.1/4, 1.1/2, 2, 2.1/2),  
3.1/2x3.1/2x(1.1/4, 1.1/2, 2, 2.1/2, 3),  
4x4x(2, 2.1/2, 3, 3.1/2)



**45° Elbow**  
(WEA 504)

C x C  
1/4, 3/8, 1/2, 5/8,  
3/4, 1, 1.1/4, 1.1/2,  
2, 2.1/2, 3, 3.1/2, 4



**Reducing Tee End**  
(WEA 508)

C x C x C  
1/4x1/8x1/4, 3/8x1/4x3/8,  
1/2x(1/4, 3/8)x1/2,  
5/8x(1/4, 3/8, 1/2)x5/8,  
3/4x(3/8, 1/2, 5/8)x3/4,  
1x(1/2, 5/8, 3/4)x1,  
1.1/4x(1/2, 3/4, 1)x1.1/4,  
1.1/2x(1/2, 3/4, 1, 1.1/4)x1.1/2,  
2x(1, 1.1/4, 1.1/2)x2,  
2.1/2x(1.1/4, 1.1/2, 2)x2.1/2,  
3x(1.1/2, 2, 2.1/2)x3,  
3.1/2x(2, 2.1/2, 3)x3.1/2,  
4x(2.1/2, 3, 3.1/2)x4

## END FEED FITTINGS (ASME)



C x C x C  
 1/4x1/4x3/8,  
 3/8x3/8x1/2,  
 1/2x1/2x (5/8,3/4),  
 5/8x5/8x(3/4, 1),  
 3/4x3/4x (1, 1.1/4),  
 1x1x (1.1/4, 1.1/2),  
 1.1/4x1.1/4x(1.1/2, 2),  
 1.1/2x1.1/2x(2, 2.1/2)

**Reducing Tee Both End  
 (WEA 509)**



C x F  
 mm x BSP  
 15 x 1/2", 22 x 3/4",  
 28 x 1", 35 x 1.1/4",  
 42 x 1.1/2", 54 x 2"

**Female Adaptor  
 (WEA 513)**



C  
 1/4, 3/8, 1/2, 5/8,  
 3/4, 1, 1.1/4, 1.1/2,  
 2, 2.1/2, 3, 3.1/2, 4

**End Cap  
 (WEA 510)**



C x M  
 mm x BSP  
 15 x 1/2", 22 x 3/4",  
 28 x 1", 35 x 1.1/4",  
 42 x 1.1/2", 54 x 2"

**Male Adaptor  
 (WEA 514)**



C x F  
 mm x BSP  
 15 x 1/2", 22 x 3/4",  
 28 x 1", 35 x 1.1/4",  
 42 x 1.1/2", 54 x 2"

**Female Elbow  
 (WEA 511)**



C x C  
 mm  
 15, 22, 28,  
 35, 42, 54,

**Straight Union  
 (WEA 515)**



C x M  
 mm x BSP  
 15 x 1/2", 22 x 3/4",  
 28 x 1", 35 x 1.1/4",  
 42 x 1.1/2", 54 x 2"

**Male Elbow  
 (WEA 512)**

## GUNMETAL-BRONZE GATE VALVES

**WEALTHMARK** gate valves (WGV-501T-BZ Series) are manufactured in accordance with BS5154 and have a nominal working pressure of 16 bar. All gate valves are suitable for hot and cold water, oil, gas and saturated steam at low pressure.

The materials for the gate valves comply to BS1400 grade "LG2" gunmetal=BSEN1982 grade "CC491K".

All Threads are complied to BS21.

**WEALTHMARK** loose jumper stop valves (WSV-801T-BZ Series) are manufactured in accordance with BS1010 and have a nominal working pressure of 16 bar. All loose jumper stop valves are suitable for hot and cold water, oil, gas and saturated steam at low pressure.

The materials for the loose jumper stop valves comply to BS1400 grade "LG2" gunmetal=BSEN1982 grade "CC491K".

All Threads are complied to BS21.



Gunmetal-Bronze Gate Valve (WGV-501T-BZ)

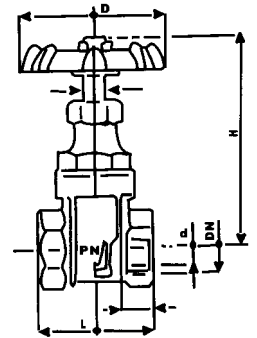

SIZE	1/2" 15mm	3/4" 20mm	1" 25mm	1.1/4" 35mm	1.1/2" 40mm	2" 50mm	2.1/2" 65mm	3" 80mm	4" 100mm
d	12.7	19	25	32	38	50	63	76	100
L	43	47	55	66	76	88	96	105	124
H	72	82	95	110	124	155	178	215	258
D	55	55	60	72	72	80	100	110	130

## GUNMETAL-BRONZE STOP VALVES



Gunmetal-Bronze Stop Valve (WSV-801T-BZ)

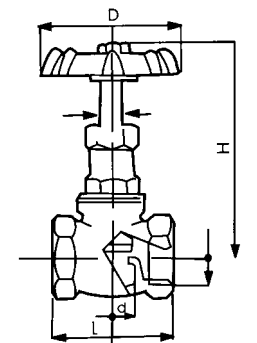

SIZE	1/2" 15mm	3/4" 20mm	1" 25mm
d	13	18	22
L	54	57	69
H	75	82.5	89
D	54	54	71

## COPPER ALLOY GATE VALVES

**WEALTHMARK** gate valves (WGV-501T Series) are manufactured in accordance with BS5154 and have a nominal working pressure of 16 bar. All gate valves are suitable for hot and cold water, oil, gas and saturated steam at low pressure.

The materials for the gate valves comply to BS1400 grade "DCB3" brass=BSEN1982 grade "CC754S", size 15mm to 50mm, the gate valve body is manufactured by forge method, size 65mm & above, by casting method. All Threads are complied to BS21.

Besides compression joint is also available in 15mm to 25mm, the model number is WGV-501C.

**WEALTHMARK** flanged gate valves (WGV-501F Series) are manufactured in accordance with BS5154 and have a nominal working pressure of 16 bar. All gate valves are suitable for hot and cold water, oil, gas and saturate steam at low pressure.

The materials for the gate valves comply to BS1400 grade "DCB3" brass=BSEN1982 grade "CC754S", the gate valve body is manufactured by casting method. All flanges are complied to BS4504 PN16.



Copper Alloy Gate Valve  
(WGV-501T)  
(WGV-501C)

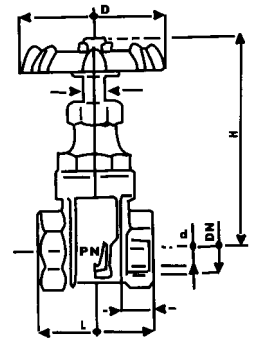

SIZE	1/2" 15mm	3/4" 20mm	1" 25mm	1.1/4" 35mm	1.1/2" 40mm	2" 50mm	2.1/2" 65mm	3" 80mm	4" 100mm
d	12.7	19	25	32	38	50	63	76	100
L	43	47	55	66	76	88	96	105	124
H	72	82	95	110	124	155	178	215	258
D	55	55	60	72	72	80	100	110	130



Copper Alloy Gate Valve  
(WGV-501F)

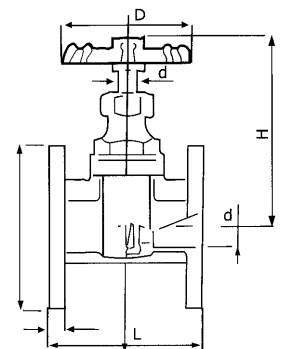

SIZE	2" 50mm	2.1/2" 65mm	3" 80mm	4" 100mm	5" 125mm	6" 150mm
d	45	56	68	90	125	150
L	125	140	160	180	170	190
H	138	170	198	242	382	430
D	110	130	178	200	200	240

## COPPER ALLOY GLOBE VALVES

**WEALTHMARK** globe valves (WGV-601T Series) are manufactured in accordance with BS5154 and have a nominal working pressure of 16 bar. All globe valves are suitable for hot and cold water, oil, gas and saturated steam at low pressure.

The materials for the globe valves comply to BS1400 grade "DCB3" brass=BSEN1982 grade "CC754S", size 15mm to 50mm, the globe valve body is manufactured by forge method, size 65mm & above, by casting method. All Threads are complied to BS21.

Besides compression joint is also available in 15mm to 25mm, the model number is WGV-601C.

**WEALTHMARK** flanged globe valves (WGV-601F Series) are manufactured in accordance with BS5154 and have a nominal working pressure of 16 bar. All globe valves are suitable for hot and cold water, oil, gas and saturate steam at low pressure.

The materials for the globe valves comply to BS1400 grade "DCB3" brass=BSEN1982 grade "CC754S", the globe valve body is manufactured by casting method. All flanges are complied to BS4504 PN16.



Copper Alloy Globe Valve  
(WGV-601T)  
(WGV-601C)

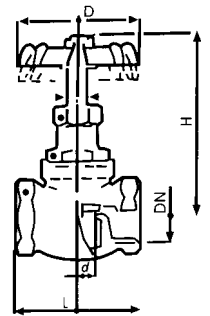

SIZE	1/2" 15mm	3/4" 20mm	1" 25mm	1.1/4" 35mm	1.1/2" 40mm	2" 50mm	2.1/2" 65mm	3" 80mm	4" 100mm
d	12.7	19	25	32	38	50	56	68	90
L	46	55	68	78	84	106	135	146	190
H	62	69	83	100	120	137	225	225	320
D	55	60	72	80	100	110	120	120	175



Copper Alloy Globe Valve  
(WGV-601F)

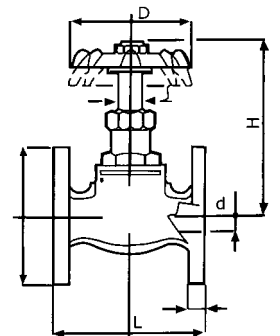

SIZE	2" 50mm	2.1/2" 65mm	3" 80mm	4" 100mm
d	50	65	80	100
L	216	236	306	335
H	160	170	260	320
D	160	180	200	240



## COPPER ALLOY CHECK VALVES

**WEALTHMARK** check valves (WCV-701T Series) are manufactured in accordance with BS5154 and have a nominal working pressure of 16 bar. All check valves are suitable for hot and cold water, oil, gas and saturated steam at low pressure.

The materials for the check valves comply to BS1400 grade "DCB3" brass=BSEN1982 grade "CC754S", size 15mm to 50mm, the check valve body is manufactured by forge method, size 65mm & above, by casting method. All Threads are complied to BS21.

**WEALTHMARK** flanged check valves (WCV-701F Series) are manufactured in accordance with BS5154 and have a nominal working pressure of 16 bar. All check valves are suitable for hot and cold water, oil, gas and saturate steam at low pressure.

The materials for the check valves comply to BS1400 grade "DCB3" brass=BSEN1982 grade "CC754S", the check valve body is manufactured by casting method. All flanges are complied to BS4504 PN16.



Copper Alloy Check Valve (WCV-701T)

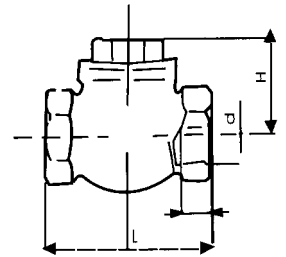

SIZE	1/2" 15mm	3/4" 20mm	1" 25mm	1.1/4" 35mm	1.1/2" 40mm	2" 50mm	2.1/2" 65mm	3" 80mm	4" 100mm
d	12.7	19	25	30	36	46	65	80	100
L	50	60	74	84	94	114	146	165	192
H	35	40	47	53	60	70	86	102	122



Copper Alloy Check Valve (WCV-701F)

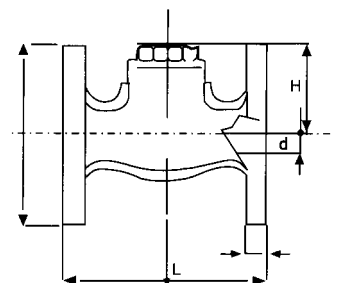

SIZE	2" 50mm	2.1/2" 65mm	3" 80mm	4" 100mm	5" 125mm	6" 150mm
d	50	65	80	100	125	150
L	146	164	182	212	300	350
H	86	94	109	125	146	180

## COPPER ALLOY STOP VALVES

**WEALTHMARK** loose jumper stop valves (WSV-801T Series) are manufactured in accordance with BS1010 and have a nominal working pressure of 16 bar. All loose jumper stop valves are suitable for hot and cold water, oil, gas and saturated steam at low pressure.

The materials for the loose jumper stop valves comply to BS1400 grade "DCB3" brass=BSEN1982 grade "CC754S", size 15mm to 25mm, the loose jumper stop valve body is manufactured by forge method.

All Threads are complied to BS21.

Besides threaded joint, compression joint is also available, the model number is WSV-801C.

**WEALTHMARK** ball valves (WBV-901T Series) are manufactured in accordance with British Standard and have a nominal working pressure of 16 bar. All ball valves are suitable for hot and cold water, oil, gas and saturate steam at low pressure.

The materials for the ball valves comply to BS1400 grade "DCB3" brass=BSEN1982 grade "CC754S", size 15mm to 50mm, the ball valve body is manufactured by forge method, size 65mm & above by casting method. All threads are complied to BS21.



Copper Alloy Stop Valve  
(WSV-801T)  
(WSV-801C)

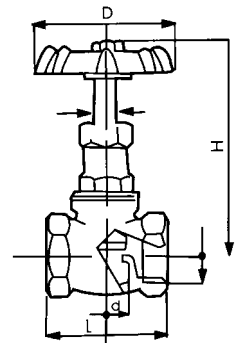

SIZE	1/2" 15mm	3/4" 20mm	1" 25mm
d	13	18	22
L	54	57	69
H	75	82.5	89
D	54	54	71

## COPPER ALLOY BALL VALVES



Copper Alloy Ball Valve  
(WBV-901T)

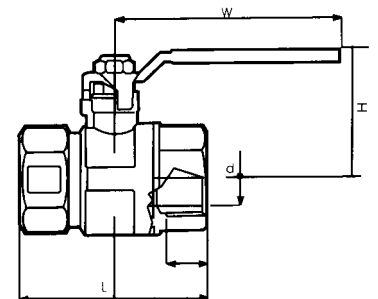

SIZE	1/2" 15mm	3/4" 20mm	1" 25mm	1.1/4" 35mm	1.1/2" 40mm	2" 50mm	2.1/2" 65mm	3" 80mm	4" 100mm
d	15	19	24	32	38	48	60	73	90
L	52	61	70	85	93	108	131	144	169
H	41	51	55	71	75	87	102	114	130
W	100	100	115	128	160	170	190	207	207



 **WEALTHMARK Limited**

Unit 1403B, 14/F., Block B, Sea View Estate,  
4-6 Watson Road, North Point, Hong Kong.

Tel: (852) 2803 5321 Fax: (852) 2575 8483

Website: [www.wmark.com.hk](http://www.wmark.com.hk)

Email: [wealthmk@wmark.com.hk](mailto:wealthmk@wmark.com.hk)